

FITTINGS FOR BUTT WELDING

Fittings, metric series ISO-UNI



FITTINGS FOR BUTT WELDING

Series of fittings designed for conveying fluids under pressure with a weld connection system (butt welding).

FITTINGS, METRIC SERIES ISO-UNI

Technical specifications	
Size range	d 20 ÷ d 630 (mm)
Nominal pressure	SDR 17, 6 (PN6) with water at 20 °C SDR 11 (PN10) with water at 20 °C
Temperature range	0 °C ÷ 100 °C
Coupling standards	Welding: EN ISO 15494. Can be coupled to pipes according to EN ISO 15494 Flanging system: ISO 7005-1, EN 1092-1, EN ISO 15494, ANSI B16.5 cl.150
Reference standards	Construction criteria: EN ISO 15494 Test methods and requirements: EN ISO 15494 Installation criteria: DVS 2202-1, DVS 2207-11, DVS 2208-1, UNI 11397
Fitting material	PP-H
Seal material	EPDM, FKM

TECHNICAL DATA

PRESSURE VARIATION ACCORDING TO TEMPERATURE

For water and non-hazardous fluids with regard to which the material is classified as CHEMICALLY RESISTANT. In other cases, a reduction of the nominal pressure PN is required.

A = SDR 11 ISO-S5 - 5 years

B = SDR 11 ISO-S5 - 25 years

C = SDR 17.6 ISO-S8.3 - 5 years

D = SDR 17.6 ISO-S8.3 - 25 years

Permissible internal pressure .Safety

factor = 1.7

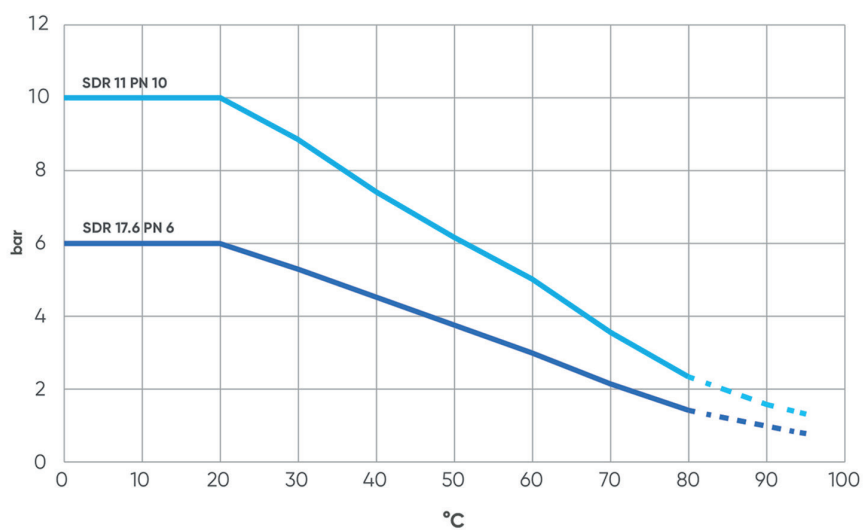

DIMENSIONS

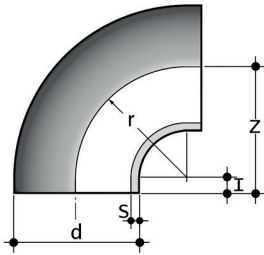

GBM/GKM

90° bend, short spigot for butt welding SDR 17,6 - 8,3

d	l	r	s	z	g	PN6 code SDR 17,6 - S 8,3
50	23	36	2,9	62	48,7	GKM17050
63	21	65	3,6	77	101,1	GKM17063
75	21	75	4,3	85	137,7	GKM17075
90	22	90	5,1	100	234	GKM17090
110	25	110	6,3	120	412	GKM17110
125	15	125	7,1	140	652	GBM17125
140	15	140	8,0	155	900	GBM17140
160	15	160	9,1	175	1231	GBM17160
180	15	180	10,2	195	1875	GBM17180
200	15	200	11,4	215	2423	GBM17200
225	20	225	13,4	245	3469	GBM17225
250	25	250	14,2	275	4568	GBM17250
280	30	280	15,9	310	6550	GBM17280
315	35	315	17,9	350	9728	GBM17315
*355	38	355	20,1	385	12760	GBM17355
*400	41	400	22,7	438	18500	GBM17400
*450	60	450	25,5	510	40800	GBM17450
*500	60	500	28,3	560	52150	GBM17500

*resale products

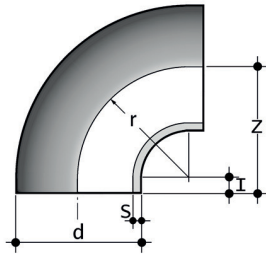

GBM/GKM

90° bend, short spigot for butt welding SDR 11 - S 5

d	l	r	s	Z	g	PN 10 code SDR 11 - S 5
20	20	18	1,9	34	6,9	GKM11020
25	20	18	2,3	37	11	GKM11025
32	21	20	2,9	40	19,1	GKM11032
40	22	35	3,7	51	37,4	GKM11040
50	23	36	4,6	62	70	GKM11050
63	21	65	5,8	77	139,5	GKM11063
75	21	75	6,8	85	199,6	GKM11075
90	22	90	8,2	100	341,1	GKM11090
110	25	110	10,0	120	598,9	GKM11110
125	15	125	11,4	140	945	GBM11125
140	15	140	12,7	155	1300	GBM11140
160	15	160	14,6	175	1870	GBM11160
180	15	180	16,4	195	2767	GBM11180
200	15	200	18,2	215	3604	GBM11200
225	15	225	20,5	235	4844	GBM11225
250	25	250	22,7	275	7210	GBM11250
280	30	280	25,4	310	10020	GBM11280
315	35	315	28,6	350	13965	GBM11315
355	28	355	32,2	378	19370	GBM11355
*400	41	400	36,3	438	28650	GBM11400
*450	60	450	40,9	510	52551	GBM11450
*500	60	500	45,4	560	67410	GBM11500

*resale products

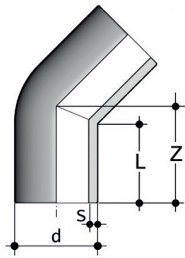

HBM

45° bend, long spigot for butt welding SDR 17,6 - 8,3

d	L	Z	s	g	PN6 code SDR 17,6 - S 8,3
*50	62	76	2,9	80	HBM17050
*63	66	88	3,6	142	HBM17063
*75	71	90	4,3	196	HBM17075
*90	82	105	5,1	325	HBM17090
*110	93	121	6,3	560	HBM17110
*125	98	137	7,1	790	HBM17125
*140	120	168	8	1245	HBM17140
*160	143	190	9,1	1850	HBM17160
*180	141	196	10,2	2335	HBM17180
*200	152	207	11,4	3130	HBM17200
*225	153	210	12,8	3970	HBM17225
*250	133	220	14,2	5780	HBM17250
*280	142	227	15,9	7285	HBM17280
*315	155	250	17,9	9850	HBM17315

*resale products

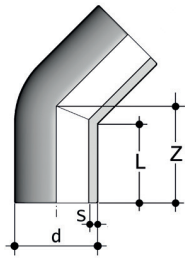

HBM

45° bend, long spigot for butt welding SDR 11 - S 5

d	L	Z	s	g	PN10 code SDR 11 - S 5
*20	52	72	1,9	19	HBM11020
*25	57	76	2,3	30	HBM11025
*32	71	90	2,9	56	HBM11032
*40	73	95	3,7	88	HBM11040
*50	62	76	4,6	110	HBM11050
*63	66	88	5,8	205	HBM11063
*75	71	90	6,8	290	HBM11075
*90	83	105	8,2	460	HBM11090
*110	93	121	10	785	HBM11110
*125	98	137	11,4	1130	HBM11125
*140	122	168	12,7	1685	HBM11140
*160	143	190	14,6	2550	HBM11160
*180	141	196	16,4	3285	HBM11180
*200	153	207	18,2	4540	HBM11200
*225	153	210	20,5	5750	HBM11225
*250	134	220	22,7	7875	HBM11250
*280	143	227	25,4	10060	HBM11280
*315	155	250	28,6	13675	HBM11315

*resale products

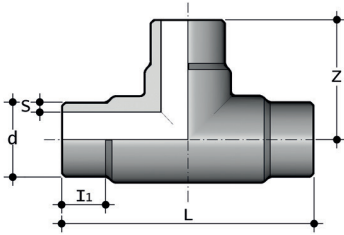

TBM

90° Tee, short spigot for butt welding SDR 17,6 - S 5

d	I ₁	L	s	Z	g	PN6 code SDR 17,6 - S 8,3
50	21	124	2,9	62	80	TBM17050
63	24	156	3,6	78	175	TBM17063
75	28	180	4,3	90	280	TBM17075
90	42	200	5,1	100	540	TBM17090
*110	57	260	6,3	130	925	TBM17110
*125	50	320	7,1	125	1133	TBM17125
*140	63	320	8,0	160	1765	TBM17140
*160	57	320	9,1	160	2335	TBM17160
*180	97	434	10,2	217	4000	TBM17180
*200	94	440	11,4	220	5060	TBM17200
*225	75	454	12,8	227	6870	TBM17225
*280	88	532	15,9	266	10680	TBM17280
*315	86	566	17,9	283	14105	TBM17315
*355	103	690	20,1	345	21900	TBM17355
*400	105	734	22,7	367	26300	TBM17400
*450	138	838	25,5	419	42715	TBM17450
*500	165	954	28,3	477	59500	TBM17500

*resale products

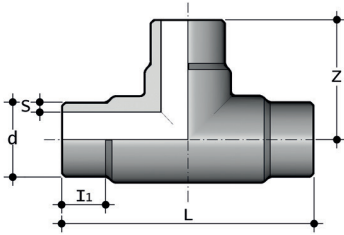

TBM

90° Tee, short spigot for butt welding SDR 11 - S 5

d	I ₁	L	s	Z	g	PN10 code SDR 11 - S 5
20	8	50	1,9	25	11	TBM11020
25	10	60	2,3	30	15	TBM11025
32	12	80	2,9	40	30	TBM11032
40	16	96	3,7	48	55	TBM11040
50	21	124	4,6	62	115	TBM11050
63	24	156	5,8	78	230	TBM11063
75	28	180	6,8	90	390	TBM11075
90	23	200	8,2	100	645	TBM11090
110	43	240	10,0	120	1040	TBM11110
*125	52	250	11,4	125	1600	TBM11125
140	63	318	12,7	159	2480	TBM11140
160	57	320	14,6	160	3250	TBM11160
*180	94	430	16,4	215	5475	TBM11180
*200	90	440	18,2	220	6810	TBM11200
225	76	450	20,5	225	9240	TBM11225
*250	68	454	22,7	227	10400	TBM11250
280	87	534	25,4	267	15170	TBM11280
315	86	566	28,6	283	20330	TBM11315
*355	103	698	32,2	349	30200	TBM11355
*400	105	720	36,3	360	39100	TBM11400
*450	137	838	40,9	419	61129	TBM11450
*500	160	930	45,4	465	84230	TBM11500

*resale products

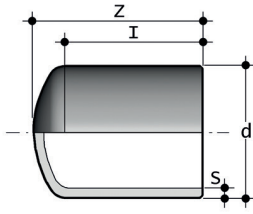

CBM

Long spigot end cap for butt welding SDR 17,6 - S 8,3

d	I	S	Z	g	PN6 code SDR 17,6 - S 8,3
125	95	7,1	124	360	CBM17125
140	110	8	136	485	CBM17140
160	121	9,1	161	735	CBM17160
180	134	10,2	167	990	CBM17180
200	140	11,4	184	1310	CBM17200
225	160	12,8	200	1790	CBM17225
*250	-	14,2	45	1520	CBM17250
*280	-	15,9	45	2070	CBM17280
*315	-	17,9	50	2940	CBM17315
*355	-	20,1	55	4170	CBM17355
*400	-	22,7	60	5960	CBM17400
*450	-	25,5	70	8520	CBM17450
*500	-	28,4	75	11600	CBM17500
*560	-	31,7	80	16000	CBM17560
*630	-	35,7	90	22900	CBM17630
*710	-	40,2	120	33500	CBM17710
*800	-	45,3	130	47500	CBM17800

*short spigot
all resale products

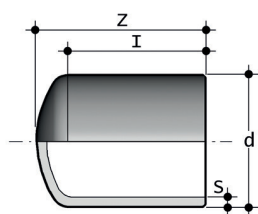

CBM

Long spigot end cap for butt welding SDR 11 - S 5

d	l	S	Z	g	PN10 code SDR 11 - S 5
20	42	1,9	49	5	CBM11020
25	42	2,3	52	6	CBM11025
32	47	2,9	57	16	CBM11032
40	51	3,7	64	23	CBM11040
50	59	4,6	72	48	CBM11050
63	67	5,8	86	87	CBM11063
75	73	6,8	94	138	CBM11075
90	83	8,2	112	222	CBM11090
110	90	10,0	124	375	CBM11110
125	94	11,4	130	520	CBM11125
140	99	12,7	142	695	CBM11140
160	109	14,6	162	1040	CBM11160
180	141	16,4	191	1375	CBM11180
200	127	18,2	181	1860	CBM11200
225	129	20,5	205	2680	CBM11225
*250	-	22,7	50	1840	CBM11250
*280	-	25,4	55	2560	CBM11280
*315	-	28,6	60	3600	CBM11315
*355	-	32,2	65	5040	CBM11355
*400	-	36,3	70	7240	CBM11400
*450	-	40,9	80	10200	CBM11450
*500	-	45,4	85	14000	CBM11500

*short spigot
all resale products

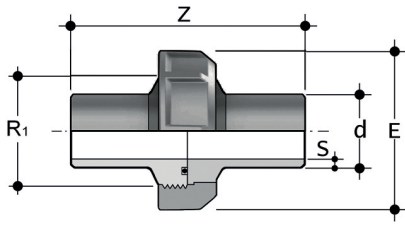

BBM-L

Long spigot union for butt welding with seal in EPDM or FKM SDR 11 - S5

d	DN	R ₁	E	s	Z	g	*EPDM PN10 code SDR 11 - S 5	**FKM PN10 code SDR 11 - S 5
20	15	1"	46	1,9	190	70	BBML11020E	BBML11020F
25	20	1 1/4"	56	2,3	190	105	BBML11025E	BBML11025F
32	25	1 1/2"	66	2,9	190	140	BBML11032E	BBML11032F
40	32	2"	79	3,7	190	210	BBML11040E	BBML11040F
50	40	2 1/4"	87	4,6	190	295	BBML11050E	BBML11050F
63	50	2 3/4"	107	5,8	190	480	BBML11063E	BBML11063F

* EPDM O-ring
** FKM O-ring

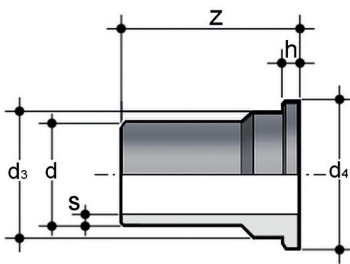

Q/BBM-L

Union end, long spigot, for butt welding for union BBM-L SDR 11 - S5

d	d ₃	d ₄	h	s	Z	g	PN10 code SDR 11 - S 5
20	27,4	30	5	1,9	95	20	QBBML11020
25	35,9	38,7	6	2,3	95	40	QBBML11025
32	41,4	44,6	6	2,9	95	45	QBBML11032
40	52,8	56,4	7	3,7	95	75	QBBML11040
50	58,8	62,5	7	4,6	95	110	QBBML11050
63	73,8	78,3	8	5,8	95	160	QBBML11063

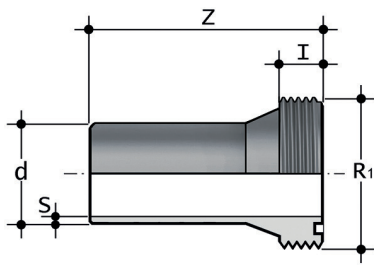

F/BMM-L

Union bush, long spigot, for butt welding for union BBM-L SDR 11 - S5

d	R ₁	l	s	Z	g	PN10 code SDR 11 - S 5
20	1"	13	1,9	95	25	FBBML11020
25	1 ¹ / ₄ "	13	2,3	95	40	FBBML11025
32	1 ¹ / ₂ "	14	2,9	95	50	FBBML11032
40	2"	16	3,7	95	80	FBBML11040
50	2 ¹ / ₄ "	18	4,6	95	115	FBBML11050
63	2 ³ / ₄ "	20	5,8	95	185	FBBML11063

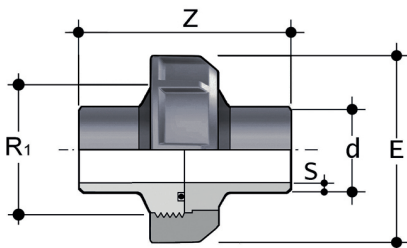

BBM-C

Short spigot union for butt welding with seal in EPDM or FKM SDR 11 - S5

d	DN	E	S	Z	g	*EPDM PN10 code SDR 11 - S 5	**FKM PN10 code SDR 11 - S 5
20	15	46	1,9	108	80	BBMC11020E	BBMC11020F
25	20	56	2,3	108	75	BBMC11025E	BBMC11025F
32	25	66	2,9	108	120	BBMC11032E	BBMC11032F
40	32	79	3,7	108	175	BBMC11040E	BBMC11040F
50	40	87	4,6	108	240	BBMC11050E	BBMC11050F
63	50	107	5,8	108	440	BBMC11063E	BBMC11063F
***75	65	120	6,8	108	648	BBMC11075E	BBMC11075F
***90	80	153	8,2	180	898	BBMC11090E	BBMC11090F
***110	100	163	10,0	180	1658	BBMC11110E	BBMC11110F

* EPDM O-ring

** FKM O-ring

***Reduced PN (6 bar), with PVC nut only

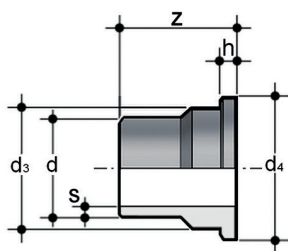

Q/BBM-C

Short spigot PP-H end connectors for butt welding SDR 11 - S5

d	d ₃	d ₄	h	s	z	g	PN10 code SDR 11 - S 5
20	27,4	30	5	1,9	54	20	QBBMC11020
25	35,9	38,7	6	2,3	54	22	QBBMC11025
32	41,4	44,6	6	2,9	54	36	QBBMC11032
40	52,8	56,4	7	3,7	54	54	QBBMC11040
50	58,8	62,5	7	4,6	54	76	QBBMC11050
63	73,8	78,3	8	5,8	54	118	QBBMC11063

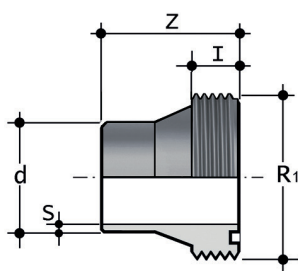

F/BBM-C

Union bush, short spigot, for butt welding for union BBM-C SDR 11 - S5

d	R	I	s	z	g	PN10 code SDR 11 - S 5
20	1"	13	1,9	54	20	FBBMC11020
25	1 ¹ / ₄ "	13	2,3	54	27	FBBMC11025
32	1 ¹ / ₂ "	14	2,9	54	40	FBBMC11032
40	2"	16	3,7	54	60	FBBMC11040
50	2 ¹ / ₄ "	18	4,6	54	86	FBBMC11050
63	2 ³ / ₄ "	20	5,8	54	147	FBBMC11063

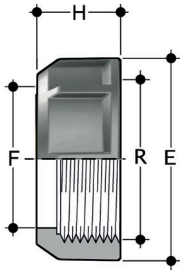

EFGM

Union nut with BSP thread for union types BIGM, BIFGM, BIFOM, BIROM, BIFXM, BIRXM

R	d BIGM	PN	E	F	H	g	Code
1"	20	10	47	28	22	19	EFGM100
1 1/4"	25	10	58	36	25	29	EFGM114
1 1/2"	32	10	65	42	27	40	EFGM112
2"	40	10	78	53	30	57	EFGM200
2 1/4"	50	10	85	59	33	74	EFGM214
2 3/4"	63	10	103	74	38	119	EFGM234

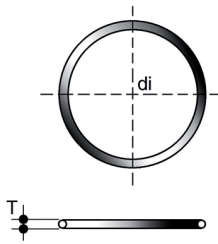

O-RING

Seals for union types BIGM, BIFGM, BIFOM, BIROM, BIFXM, BIRXM

d union	C	di	T	EPDM code	FKM code
16	3062	15,54	2,62	OR3062E	OR3062F
20	4081	20,22	3,53	OR4081E	OR4081F
25	4112	28,17	3,53	OR4112E	OR4112F
32	4131	32,93	3,53	OR4131E	OR4131F
40	6162	40,65	5,34	OR6162E	OR6162F
50	6187	47	5,34	OR6187E	OR6187F
63	6237	59,69	5,34	OR6237E	OR6237F
75	6300	75,57	5,34	OR6300E	OR6300F
90	6362	91,45	5,34	OR6362E	OR6362F
110	6450	113,67	5,34	OR6450E	OR6450F

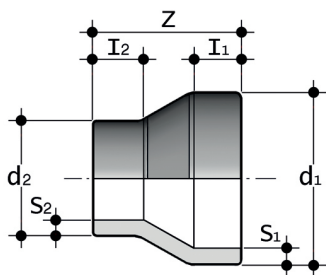

RBM

Concentric reducer, short spigot, for butt welding SDR 17,6 - S 8,3

d ₁	d ₂	l ₁	l ₂	Z	S ₁	S ₂	g	PN6 code SDR 17,6 - S 8,3
50	32	12	12	55	2,9	2,0	17	RBM17050032
50	40	12	12	55	2,9	2,3	20	RBM17050040
63	32	16	12	65	3,6	2,0	32	RBM17063032
63	40	16	12	65	3,6	2,3	36	RBM17063040
63	50	16	12	65	3,6	2,9	38	RBM17063050
75	50	19	12	71	4,3	2,9	54	RBM17075050
75	63	19	16	71	4,3	3,6	60	RBM17075063
90	63	22	16	80	5,1	3,6	82	RBM17090063
*90	75	31	26	91	5,1	4,3	120	RBM17090075
*110	63	40	36	105	6,3	3,6	170	RBM17110063
*110	75	40	28	96	6,3	4,3	170	RBM17110075
*110	90	42	42	100	6,3	5,1	190	RBM17110090
*160	110	40	34	129	9,1	6,3	500	RBM17160110
*180	90	53	42	145	10,2	5,1	600	RBM17180090
*200	160	62	52	145	11,4	9,1	900	RBM17200160
*225	160	65	53	162	12,8	9,1	1150	RBM17225160
*280	200	85	70	200	15,9	11,4	2340	RBM17280200
*280	225	70	55	200	15,9	12,8	2370	RBM17280225
*315	250	95	95	230	17,9	14,2	3450	RBM17315250
*400	225	74	40	170	22,7	12,7	5700	RBM17400225
*400	250	66	40	155	22,7	14,2	4900	RBM17400250
*400	280	59	40	140	22,7	15,9	4300	RBM17400280
*400	315	55	40	125	22,7	17,9	3700	RBM17400315
*400	355	46	40	105	22,7	20,1	3000	RBM17400355
*450	280	70	40	165	25,5	15,9	6700	RBM17450280
*450	315	65	40	150	25,5	17,9	6000	RBM17450315
*450	355	57	40	130	25,5	20,1	4900	RBM17450355
*450	400	45	40	105	25,5	22,7	3700	RBM17450400
*500	315	75	40	175	28,4	17,9	9000	RBM17500315
*500	355	67	40	155	28,4	20,1	7600	RBM17500355
*500	400	60	40	135	28,4	22,7	6400	RBM17500400
*500	450	50	40	110	28,4	25,5	4900	RBM17500450
*560	400	73	40	165	31,7	22,7	10400	RBM17560400
*560	450	62	40	140	31,7	25,5	8300	RBM17560450
*560	500	52	40	115	31,7	28,4	6500	RBM17560500
*630	400	87	40	200	35,7	22,7	16900	RBM17630400
*630	450	77	40	175	35,7	25,5	14100	RBM17630450
*630	500	67	40	150	35,7	28,4	11500	RBM17630500
*630	560	54	40	120	35,7	31,7	8600	RBM17630560
*710	500	88	40	195	40,2	25,5	8900	RBM17710500
*710	560	76	40	165	40,2	28,4	16600	RBM17710560
*710	630	61	40	130	40,2	35,7	12200	RBM17710630
*800	560	95	40	210	45,3	31,7	28700	RBM17800560
*800	630	80	40	175	45,3	35,7	22500	RBM17800630
*800	710	63	40	135	45,3	40,2	16100	RBM17800710

*resale products

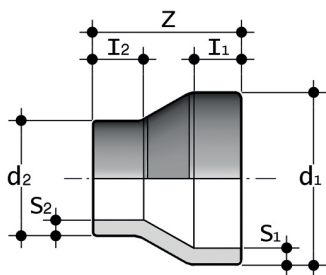

RBM

Concentric reducer, short spigot, for butt welding SDR 11 - S 5

d ₁	d ₂	l ₁	l ₂	Z	S ₁	S ₂	g	PN10 code SDR 11 - S 5
25	20	12	12	37	2,3	1,9	5	RBM11025020
32	20	12	12	43	2,9	1,9	8	RBM11032020
32	25	12	12	43	2,9	2,3	10	RBM11032025
40	20	12	12	50	3,7	1,9	13	RBM11040020
40	25	12	12	50	3,7	2,3	15	RBM11040025
40	32	12	12	50	3,7	3,0	18	RBM11040032
50	25	12	12	55	4,6	2,3	23	RBM11050025
50	32	12	12	55	4,6	3,0	25	RBM11050032
50	40	12	12	55	4,6	3,7	29	RBM11050040
63	32	27	25	89	5,8	2,9	64	RBM11063032
63	40	16	12	65	5,8	3,7	50	RBM11063040
63	50	25	25	87	5,8	4,6	79	RBM11063050
*75	50	19	14	59	6,8	4,6	70	RBM11075050
75	63	25	26	89	6,8	5,8	112	RBM11075063
90	50	28	25	93	8,2	4,6	145	RBM11090050
90	63	22	16	80	8,2	5,8	129	RBM11090063
*90	75	31	26	90	8,2	6,8	174	RBM11090075
*110	50	28	20	96	10	4,6	210	RBM11110050
110	63	28	16	97	10,0	5,8	200	RBM11110063
110	75	40	28	96	10,0	6,8	263	RBM11110075
*110	90	41	40	105	10,0	8,2	280	RBM11110090
*125	110	40	40	100	11,4	10	380	RBM11125110
140	90	50	40	130	12,7	8,2	530	RBM11140090
140	110	50	40	120	12,7	10,0	540	RBM11140110
*140	125	35	32	115	12,7	11,4	600	RBM11140125
160	90	48	34	141	14,6	8,2	695	RBM11160090
160	110	40	28	124	14,6	10,0	430	RBM11160110
*160	125	40	32	122	14,6	11,4	725	RBM11160125
160	140	49	38	125	14,6	12,7	725	RBM11160140
200	160	50	40	151	18,2	14,6	700	RBM11200160
*225	140	61	48	157	20,5	12,7	1575	RBM11225140
225	160	55	40	171	20,5	14,6	960	RBM11225160
*280	200	75	54	214	25,4	18,2	3450	RBM11280200
*280	225	72	57	203	25,4	20,5	3425	RBM11280225
*315	200	80	50	200	28,6	18,2	4000	RBM11315200
315	225	84	60	237	28,6	20,5	5110	RBM11315225
*315	250	86	63	231	28,6	22,7	5105	RBM11315250
*315	280	80	70	222	28,6	25,4	5130	RBM11315280
*400	225	79	40	175	36,3	20,5	7700	RBM11400225
*400	250	71	40	160	36,3	22,7	6800	RBM11400250
*400	280	64	40	145	36,3	25,4	6100	RBM11400280
*400	315	60	40	130	36,3	28,6	5600	RBM11400315
*400	355	51	40	110	36,3	32,2	4600	RBM11400355
*450	280	80	40	175	40,9	25,4	9800	RBM11450280
*450	315	70	40	155	40,9	28,6	8400	RBM11450315
*450	355	62	40	135	40,9	32,2	7200	RBM11450355
*450	400	55	40	115	40,9	36,3	6200	RBM11450400

d_1	d_2	l_1	l_2	Z	s_1	s_2	g	PN10 code SDR 11 - S 5
*500	315	85	40	185	45,4	28,6	13000	RBM11500315
*500	355	77	40	165	45,4	32,2	11400	RBM11500355
*500	400	65	40	140	45,4	36,3	9400	RBM11500400
*500	450	55	40	115	45,4	40,9	7600	RBM11500450

*resale products

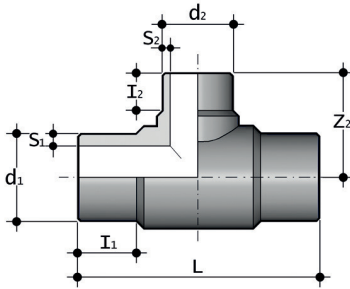

TRBM

90° reducing Tee, short spigot for butt welding SDR 17,6 - S 8,3

d_1	d_2	l_1	l_2	L	s_1	s_2	Z_2	g	PN6 code SDR 17,6 - S 8,3
*63	50	63	56	220	3,8	3	103	208	TRBM17063050
*75	50	70	55	253	4,5	3	113	406	TRBM17075050
*75	63	70	63	260	4,5	3,8	117	415	TRBM17075063
*90	63	79	63	275	5,4	3,8	137	591	TRBM17090063
*90	75	74	70	278	5,4	4,5	138	570	TRBM17090075
*110	63	85	66	315	6,6	3,8	159	957	TRBM17110063
*110	75	82	70	315	6,6	4,5	157	850	TRBM17110075
*110	90	82	79	315	6,6	5,4	155	915	TRBM17110090
*125	63	70	31	271	7,4	3,8	112	1380	TRBM17125063
*125	110	87	82	340	7,4	6,6	170	1235	TRBM17125110
140	63	86	32	302	8,3	3,8	120	1311	TRBM17140063
140	75	86	35	300	8,3	4,5	130	1400	TRBM17140075
140	90	86	42	300	8,3	5,4	130	1320	TRBM17140090
140	110	50	53	300	8,3	6,6	139	1640	TRBM17140110
*160	63	98	64	347	9,5	3,8	175	1920	TRBM17160063
*160	75	98	75	348	9,5	4,5	179	1905	TRBM17160075
*160	90	100	81	349	9,5	5,4	182	1940	TRBM17160090
*160	110	98	85	400	9,5	6,6	202	2360	TRBM17160110
160	125	62	48	315	9,5	7,4	150	2040	TRBM17160125
180	63	130	32	358	10,7	3,8	139	2060	TRBM17180063
180	75	120	31	360	10,7	4,5	140	2100	TRBM17180075
*180	90	134	97	420	10,7	5,4	200	3100	TRBM17180090
180	110	106	48	365	10,7	6,6	160	2160	TRBM17180110
180	125	92	50	358	10,7	7,4	156	2240	TRBM17180125
*200	63	134	80	550	11,9	3,8	225	4963	TRBM17200063
*200	90	134	95	550	11,9	5,4	227	5124	TRBM17200090
*200	110	134	103	560	11,9	6,6	245	5220	TRBM17200110
*200	125	134	110	550	11,9	7,4	240	5260	TRBM17200125
*200	160	134	114	550	11,9	9,5	265	6154	TRBM17200160
*225	75	120	75	451	13,4	4,5	226	4900	TRBM17225075
*225	90	120	79	450	13,4	5,4	224	5000	TRBM17225090
*225	110	120	86	449	13,4	6,6	226	4960	TRBM17225110
225	125	140	45	455	13,4	7,4	180	4190	TRBM17225125
*225	160	120	98	498	13,4	9,5	250	6260	TRBM17225160
*225	180	134	134	558	13,4	10,7	280	7100	TRBM17225180

*long spigot
All resale products

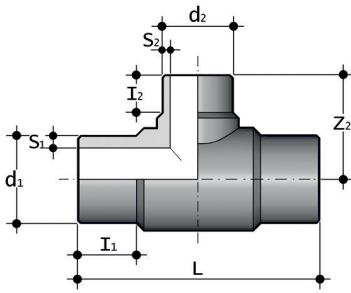

TRBM

90° reducing Tee, short spigot for butt welding SDR 11 - S 5

d ₁	d ₂	i ₁	i ₂	L	s ₁	s ₂	Z ₂	g	PN10 code SDR 11 - S 5
*63	50	63	56	220	4,6	4,6	103	292	TRBM11063050
*75	32	70	46	256	6,8	2,9	103	498	TRBM11075032
*75	50	75	56	265	4,6	4,6	113	530	TRBM11075050
*75	63	72	63	260	5,8	5,8	117	537	TRBM11075063
90	32	53	23	203	8,2	2,9	85	562	TRBM11090032
90	50	53	28	213	8,2	4,6	100	563	TRBM11090050
*90	63	82	66	282	8,2	5,8	127	739	TRBM11090063
*90	75	73	68	280	8,2	6,8	138	796	TRBM11090075
110	32	66	22	234	10	2,9	91	906	TRBM11110032
110	50	70	27	244	10	4,6	103	945	TRBM11110050
*110	63	88	68	328	10	5,8	149	1240	TRBM11110063
*110	75	86	70	320	10	6,8	151	1180	TRBM11110075
*110	90	86	79	320	10	8,2	158	1261	TRBM11110090
125	63	76	31	280	11,4	5,8	112	1400	TRBM11125063
*125	90	112	92	340	11,4	8,2	170	1640	TRBM11125090
*125	110	90	83	341	11,4	10	170	1850	TRBM11125110
140	63	87	32	302	12,7	5,8	120	1800	TRBM11140063
140	75	54	35	305	12,7	6,8	130	1920	TRBM11140075
140	90	88	42	305	12,7	8,2	130	1840	TRBM11140090
140	110	50	44	291	12,7	10	140	2180	TRBM11140110
*160	63	100	67	347	14,6	5,8	175	2560	TRBM11160063
*160	75	98	74	343	14,6	6,8	180	2620	TRBM11160075
*160	90	104	83	412	14,6	8,2	190	2620	TRBM11160090
*160	110	104	89	414	14,6	10	200	3160	TRBM11160110
160	125	62	52	335	14,6	11,4	158	2720	TRBM11160125
180	63	134	32	367	16,4	5,8	144	3040	TRBM11180063
180	75	123	31	366	16,4	6,8	148	3100	TRBM11180075
*180	90	138	97	427	16,4	8,2	200	4240	TRBM11180090
*180	110	148	101	464	16,4	10	225	4600	TRBM11180110
180	125	100	52	366	16,4	11,4	166	3280	TRBM11180125
*200	63	122	63	500	18,2	5,8	190	6940	TRBM11200063
*200	90	122	79	498	18,2	5,1	207	6860	TRBM11200090
*200	110	122	82	500	18,2	6,3	215	6980	TRBM11200110
*200	125	115	43	388	18,2	11,4	165	6920	TRBM11200125
*200	160	122	98	500	18,2	9,1	234	8340	TRBM11200160
*225	75	120	70	555	20,5	6,8	227	6620	TRBM11225075
*225	90	129	82	556	20,5	8,2	228	6660	TRBM11225090
*225	110	130	86	556	20,5	10	238	6660	TRBM11225110
225	125	135	40	456	20,5	11,4	178	6120	TRBM11225125
225	180	135	135	558	20,5	16,4	280	9800	TRBM11225180
*225	110	135	38	450	22,7	10	197	12460	TRBM11250110
*250	160	110	58	458	22,7	14,6	213	12960	TRBM11250160
*250	110	150	82	695	28,6	10	277	15680	TRBM11315110
*315	160	150	102	695	28,6	14,6	290	17020	TRBM11315160
*315	225	170	145	650	28,6	20,5	335	20580	TRBM11315225
*315	250	150	130	695	28,6	22,7	325	21840	TRBM11315250

*long spigot -all resale products

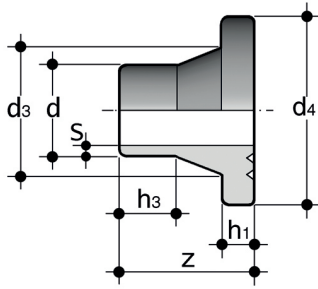

QBM

Short spigot stub for butt welding for backing rings ISO/DIN ODT/ODB SDR 17,6 - S 8,3

d	d ₃	d ₄	h ₁	h ₃	S	Z	g	PN6 code SDR 17,6 - S 8,3
63	75	102	14	18	3,6	50	115	QBM17063
75	89	122	16	35	4,3	50	180	QBM17075
90	105	138	17	43	5,1	80	280	QBM17090
110	125	158	18	37	6,3	80	365	QBM17110
125	132	158	18	45	7,1	88	380	QBM17125
140	155	188	18	39	8,0	83	510	QBM17140
160	175	212	18	52	9,1	100	745	QBM17160
180	186	212	20	62	10,2	83	650	QBM17180
200	233	268	24	75	11,4	140	1756	QBM17200
225	235	268	24	65	12,8	121	1460	QBM17225
*250	285	320	25	61	14,2	120	2170	QBM17250
280	291	321	25	88	15,9	150	1975	QBM17280
315	335	370	25	90	17,9	155	3600	QBM17315
355	373	430	30	99	20,1	184	5400	QBM17355
400	427	482	33	98	22,7	195	7120	QBM17400
*450	514	585	46	60	25,5	142	10700	QBM17450
*500	530	585	46	60	28,4	138	9195	QBM17500
*560	615	685	50	60	31,7	139	13150	QBM17560
*630	642	685	50	60	35,7	140	11685	QBM17630

*resale products

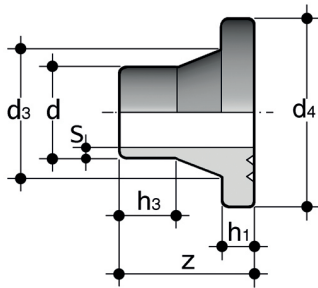

QBM

Short spigot stub for butt welding for backing rings ISO/DIN ODT/ODB SDR 11 - S 5

d	d ₃	d ₄	h ₁	h ₃	S	Z	g	PN10 code SDR 11 - S 5
20	26	46	7	29	1,9	52	18	QBM11020
25	32	59	10	27	2,3	52	33	QBM11025
32	40	68	10	26	2,9	50	44	QBM11032
40	49	78	11	24	3,7	52	65	QBM11040
50	60	89	12	27	4,6	57	85	QBM11050
63	75	102	14	16	5,8	50	129	QBM11063
75	89	122	16	14	6,8	50	200	QBM11075
90	105	138	17	33	8,2	80	322	QBM11090
110	125	158	18	27	10,0	80	430	QBM11110
125	132	158	25	40	11,4	90	540	QBM11125
140	155	188	25	39	12,7	83	715	QBM11140
160	175	212	25	27	14,6	80	915	QBM11160
180	186	212	30	65	16,4	127	1300	QBM11180
200	232	268	32	50	18,2	120	2160	QBM11200
225	235	268	32	65	20,5	127	2165	QBM11225
*250	285	320	35	51	22,7	121	2915	QBM11250
280	291	320	35	83	25,4	155	2900	QBM11280
315	335	370	35	80	28,6	155	5525	QBM11315
355	373	430	40	90	32,2	180	7730	QBM11355
400	427	482	46	95	36,3	195	10485	QBM11400
*450	514	585	60	60	40,9	139	13350	QBM11450
*500	530	585	60	60	45,4	138	12730	QBM11500

*resale products

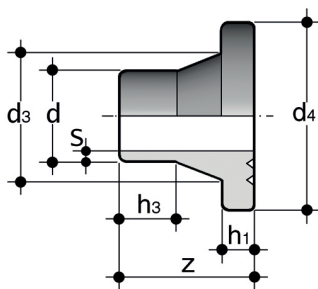

QBM special stub flange for butterfly valves PN6 SDR 17,6

Chamfered stub flange short spigot for butt welding to be used with FE/FK butterfly valves

Valve d	Pipe d	d ₃	d ₄	h ₁	h ₃	S	g	PN6 code SDR 17,6 - S 8,3
225	200	233	268	24	58	11,4	1760	QBM17FK200
280	250	285	320	25	61	14,2	2170	QBM17FK250
315	315	335	370	25	86	17,9	3600	QBM17FK315
355	355	373	430	30	99	20,1	5400	QBM17FK355
400	400	427	482	33	98	22,7	7120	QBM17FK400

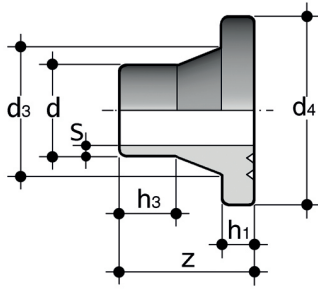

QBM special stub flange for butterfly valves PN10 SDR 11

Chamfered stub flange short spigot for butt welding, to be used with FE/FK butterfly valves

Valve d	Tubo d	d ₃	d ₄	h ₁	h ₃	S	g	PN10 code SDR 11 - S 5
160	160	175	212	25	52	14,6	1120	QBM11FK160
225	200	232	268	32	50	18,2	2160	QBM11FK200
225	225	235	268	32	65	20,5	2170	QBM11FK225
280	250	285	320	35	51	22,7	2920	QBM11FK250
280	280	291	320	35	45	22,7	3200	QBM11FK280
315	315	335	370	35	86	28,6	5530	QBM11FK315
355	355	373	430	40	90	32,2	7730	QBM11FK355
400	400	427	482	46	95	36,3	10490	QBM11FK400

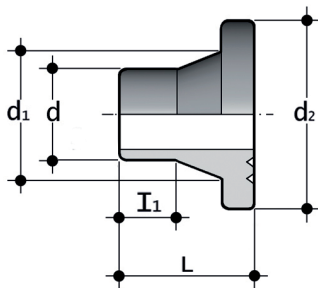

QPM Stub flange for butterfly and wafer check valves

Flat Stub flange short spigot for butt welding, for butterfly valves FE-FK and inlet side for wafer check valves CR-FR

d	DN	d ₁	d ₂	L	I ₁	PN6 code SDR 17,6 - S 8,3	PN10 code SDR 11 - S 5
50	40	61	88	47	21	QPM17050	QPM11050
63	50	75	102	47	16	QPM17063	QPM11063
75	65	89	122	47	14	QPM17075	QPM11075
90	80	105	138	76,5	33	QPM17090	QPM11090
110	100	125	158	76,5	27	QPM17110	QPM11110
125	125	132	158	76,5	35	QPM17125	QPM11125
140	125	155	188	76,5	27	QPM17140	QPM11140
160	150	175	212	76,5	34	QPM17160	QPM11160
180	150	182	212	76,5	30	QPM17180	QPM11180
200	200	232	268	96	36	QPM17200	QPM11200
225	200	235	268	96	46	QPM17225	QPM11225
250	200	285	320	96	35	QPM17250	QPM11250
280	250	291	320	96	45	QPM17280	QPM11280

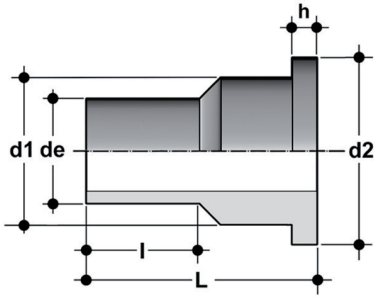

QBXM Stub flange exit side for clapet wafer check valves SDR17,6 - S8,3

Stub flange short spigot for butt welding, exit side for clapet wafer check valves

de	DN	h	l	d ₁	d ₂	L	PN6 code SDR 17,6 - S8,3
*50	40	12	20	61	90	50	QBXM17050
*63	50	14	20	77	105	54	QBXM17063
*75	65	16	20	91	125	65	QBXM17075
*90	80	17	35	107	138	95	QBXM17090
*110	100	18	35	127	160	100	QBXM17110
*125	125	25	35	132	160	100	QBXM17125
*140	125	18	35	157	190	110	QBXM17140
*160	150	18	35	186	216	125	QBXM17160
*180	150	20	40	186	216	120	QBXM17180
*200	200	24	40	236	272	180	QBXM17200
*225	200	24	40	236	272	155	QBXM17225
*250	200	25	40	292	328	205	QBXM17250
*280	250	25	40	292	328	185	QBXM17280

*resale products

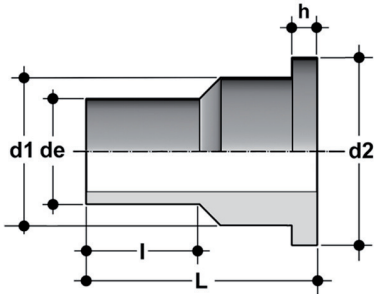

QBXM Stub flange exit side for clapet wafer check valves SDR 11 - S5

Stub flange short spigot for butt welding, exit side for clapet wafer check valves

de	DN	h	l	d ₁	d ₂	L	PN10 code SDR 11 - S5
*50	40	12	20	61	90	50	QBXM11050
*63	50	14	20	77	105	60	QBXM11063
*75	65	16	20	91	125	75	QBXM11075
*90	80	17	35	107	138	100	QBXM11090
*110	100	18	35	132	160	108	QBXM11110
*125	125	25	35	132	160	100	QBXM11125
*140	125	25	35	157	190	120	QBXM11140
*160	150	25	35	186	216	125	QBXM11160
*180	150	30	40	186	216	120	QBXM11180
*200	200	32	40	236	272	190	QBXM11200
*225	200	32	40	236	272	180	QBXM11225
*250	200	35	40	292	328	210	QBXM11250
*280	250	35	40	292	328	200	QBXM11280

*resale products

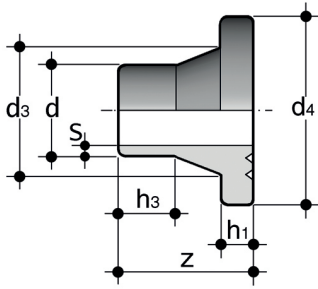

QBAM

Short spigot stub for butt welding for backing rings ANSI B16.5 cl.150 OAT* SDR 17,6 - S 8,3

d	OAB size	d ₃	d ₄	h ₁	h ₃	S	Z	g	PN6 code SDR 17,6 - S 8,3
40	1" 1/4	50	72	11	24	2,3	50	60	QBAM17114
50	1" 1/2	61	84,5	12	23	2,9	50	77	QBAM17112
90	3"	105	132	17	43	5,1	80	280	QBAM17300

for other dimensions use QBM

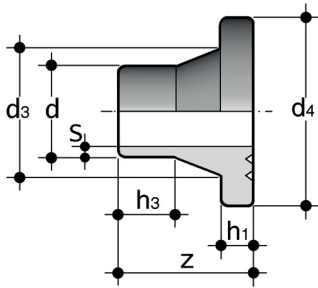

QBAM

Short spigot stub for butt welding for backing rings ANSI B16.5 cl.150 OAY* SDR 11 - S 5

d	OAB size	d ₃	d ₄	h ₁	h ₃	S	Z	g	PN10 code SDR 11 - S 5
25	3/4"	33	54	9	26	2,3	50	30	QBAM11034
32	1"	40	63,5	10	25	2,9	50	45	QBAM11100
40	1" 1/4	50	72	11	24	3,7	50	66	QBAM11114
50	1" 1/2	61	84,5	12	21	4,6	50	87	QBAM11112
90	3"	105	132	17	33	8,2	80	322	QBAM11300

for other dimensions use QBM

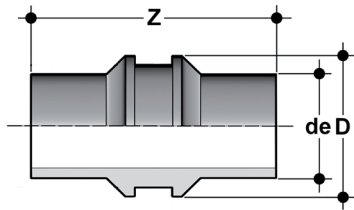

FIXP SDR 17,6

Fixed point for pipe clamp SDR 17,6

de	D	Z	g	PN6 code SDR 17,6 -S 8,3
*110	146	260	1000	FIXP17110
*125	156	260	1100	FIXP17125
*140	172	260	1400	FIXP17140
*160	184	260	1500	FIXP17160
*180	206	330	2600	FIXP17180
*200	231	330	3400	FIXP17200
*225	281	330	5300	FIXP17225
*250	286	330	5100	FIXP17250
*280	331	330	7000	FIXP17280
*315	340	330	6700	FIXP17315
*355	381	330	8300	FIXP17355
*400	426	390	12100	FIXP17400
*450	525	390	20400	FIXP17450
*500	538	390	19800	FIXP17500
*560	623	420	30400	FIXP17560
*630	678	420	34500	FIXP17630
*710	780	420	46900	FIXP17710
*800	830	420	48600	FIXP17800

*made in PPR
All resale products

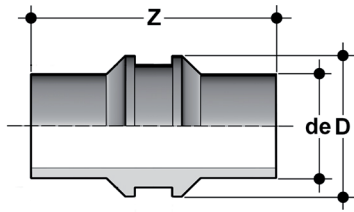

FIXP SDR 11

Fixed point for pipe clamp SDR 11

de	D	Z	g	PN10 code SDR 11 - S 5
*110	146	260	1300	FIXP11110
*125	156	260	1500	FIXP11125
*140	172	260	1800	FIXP11140
*160	184	260	2100	FIXP11160
*180	206	330	3600	FIXP11180
*200	231	330	4500	FIXP11200
*225	281	330	6700	FIXP11225
*250	286	330	6900	FIXP11250
*280	331	330	9300	FIXP11280
*315	340	330	9500	FIXP11315
*355	381	330	12000	FIXP11355
*400	426	390	17500	FIXP11400
*450	525	390	27300	FIXP11450
*500	538	390	28300	FIXP11500

*made in PPR
All resale products

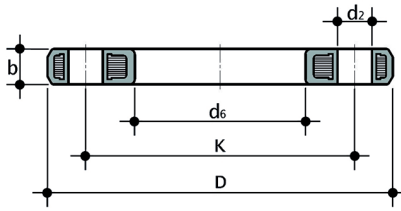

ODT

Wedge profile backing ring, with metal core and a PP-GR coating.
According to EN/ISO/DIN for stub QBM. Drilled: PN10/16 up to d180, PN10 from d200 to d315.

d	DN	*PMA (bar)	b	d ₂	d ₆	D	K	M	n	**Nm	g	Code
20	15	16	13	14.6	28	100	65	M12	4	10	215	ODT020
25	20	16	15	14.6	34	111	75	M12	4	15	308	ODT025
32	25	16	17	14.6	42	120.2	85	M12	4	15	449	ODT032
40	32	16	18	18.6	51	140	100	M16	4	20	682	ODT040
50	40	16	19	18.6	62	150	110	M16	4	25	808	ODT050
63	50	16	19	18.6	78	164	125	M16	4	35	1100	ODT063
75	65	16	19	18.6	92	186	145	M16	4	35	1200	ODT075
90	80	16	20	18.6	109	200.8	160	M16	8	35	1430	ODT090
110	100	16	20	18.6	128	221	180	M16	8	35	1498	ODT110
125	100	16	20	18.6	135	221	180	M16	8	35	1330	ODT125
140	125	16	24	18.6	158	251	210	M16	8	45	2200	ODT140
160	150	16	25	22.6	178	284	240	M20	8	70	3120	ODT160
180	150	16	25	22.6	191	284	240	M20	8	70	2590	ODT180
200	200	16	27	22.6	235	340	295	M20	8	70	4181	ODT200
225	200	16	27	22.6	238	340	295	M20	8	70	4002	ODT225
250	250	16	30	22.6	288	395.6	350	M20	12	70	5660	ODT250
280	250	16	30	22.6	294	395.6	350	M20	12	70	5182	ODT280
315	300	16	32	22.6	338	446	400	M20	12	90	7123	ODT315

*PMA maximum admissible working pressure
**maximum recommended tightening torque
n = number of bolts

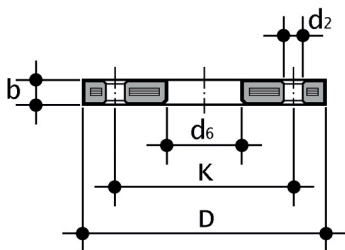

ODB

Steel core backing ring, PP/FRP coated, according to EN/ISO/DIN for stub QBM. Drilled: PN 10.

d	DN	*PMA (bar)	b	d ₂	d ₆	D	K	M	n	**Nm	g	Code
*355	350	10	39	22	376	505	460	M20	16	120	15580	ODB355
*400	400	10	44	26	429.5	570	515	M24	16	140	19890	ODB400
*450	500	10	44	26	517	670	620	M24	20	150	26010	ODB450
*500	500	10	44	26	532.5	670	620	M24	20	150	25310	ODB500
*560	600	10	50	30	618	799	725	M27	20	170	49500	ODB560
*630	600	10	50	30	645	799	725	M27	20	170	41190	ODB630

PMA maximum admissible working pressure
**nominal tightening torque
n = number of bolts
*resale products

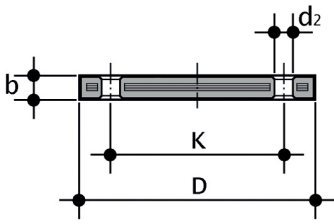

ODBC

Steel core blind flange, PP/FRP coated, according to EN/ISO/DIN. Drilling PN 10/16 up to d160/180, PN 10 from d200/225 to d400

d	DN	PMA (bar)	b	d ₂	D	k	M	n	**Nm	g	Code
*20	15	10	16	14	95	65	M12	4	15	290	ODBC020
*25	20	10	12	18	105	75	M12	4	15	380	ODBC025
*32	25	10	18	14	115	85	M12	4	15	600	ODBC032
*40	32	10	17	18	140	100	M16	4	25	830	ODBC040
*50	40	10	18	18	150	110	M16	4	35	1105	ODBC050
*63	50	10	18	18	165	125	M16	4	35	1308	ODBC063
*75	65	10	18	18	185	145	M16	4	40	1580	ODBC075
*90	80	10	20	18	200	160	M16	8	40	2244	ODBC090
*110	100	10	20	18	220	180	M16	8	45	2829	ODBC110
*140	125	10	24	18	250	210	M16	8	50	3920	ODBC140
*160	150	10	22	22	285	240	M20	8	60	7181	ODBC160
*180	150	10	24	22	285	240	M20	8	60	7130	ODBC180
*200	200	10	24	22	340	295	M20	8	70	10580	ODBC200
*250	250	10	30	22	395	350	M20	12	100	14040	ODBC250
*280	250	10	30	22	395	350	M20	12	100	14040	ODBC280
*315	300	16	34	22	445	400	M20	12	110	26480	ODBC315
*350	350	10	39	22	505	460	M20	16	160	39000	ODBC355
*400	400	10	46	25	574	515	M24	16	170	50400	ODBC400

PMA maximum admissible working pressure

**nominal tightening torque

*resale products

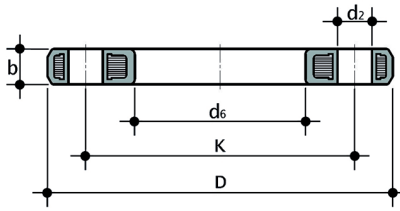

OAT

Wedge profile backing ring, with metal core and a PP-GR coating.
According to ANSI B16.5 cl.150 for stub QBM and QBAM.

d(inch)	DN	d (pollici)	DN	b	d ₂ (mm)	d ₂ (pollici)	d ₆	D	k(mm)	k(pollici)	n	**Nm	g	Code
1/2"	15	1/2"	15	13	16	5/8	28	97	60.3	2" 3/8	4	10	209	OAT012
3/4"	20	3/4"	20	15	16	5/8	34	109	69.9	2" 3/4	4	15	316	OAT034
1"	25	1"	25	17	16	5/8	42	117	79.4	3" 1/8	4	15	433	OAT100
1 1/4"	32	1 1/4"	32	18	16	5/8	51	139	88.9	3" 1/2	4	20	702	OAT114
1 1/2"	40	1 1/2"	40	19	16	5/8	62	149	98.4	3" 7/8	4	25	804	OAT112
2"	50	2"	50	19	20	3/4	78	163	120.7	4" 3/4	4	35	918	OAT200
2 1/2"	65	2 1/2"	65	19	20	3/4	92	186	139.7	5" 1/2	4	35	1155	OAT212
3"	80	3"	80	20	20	3/4	111	198	152.4	6"	4	35	1175	OAT300
4"	100	4"	100	20	20	3/4	133	232	190.5	7" 1/2	8	35	1570	OAT400
6"	150	6"	150	25	22.6	7/8	178	284	240	9" 1/2	8	70	3120	ODT160
8"	200	8"	200	28	22	7/8	236	342	298.5	11" 3/4	8	70	4200	OAT800
10"	250	10"	250	30	25	1	288	414	362	14" 1/4	12	70	6800	OAT810
12"	300	12"	300	32	25	1	338	490	431.8	17"	12	90	11060	OAT812

**maximum recommended tightening torque
n = number of bolts

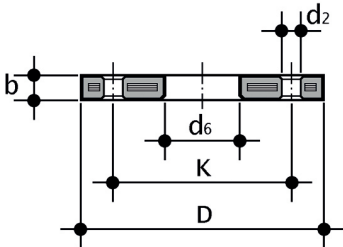

OAB

Steel core backing ring, PP/FRP coated, according to ANSI B16.5 cl.150 for stubs QBM and QBAM

d(inch)	DN	d (pollici)	DN	b	d ₂ (mm)	d ₂ (pollici)	d ₆	D	k(mm)	k(pollici)	n	**Nm	g	Code
*14"	355	*14"	355	42	28,5	1"1/8	376	533	476,2	17"3/4	12	110	24940	OAB814
*16"	400	*16"	400	44	28,5	1"1/8	430	596	539,7	18"13/32	16	110	34770	OAB816

**nominal tightening torque
*resale products

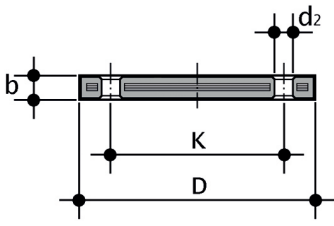

OABC

Steel core blind flange, PP/FRP coated, according to ANSI B16.5 cl.150

Inch	DN	*PMA (bar)	B	D	d ₂ (mm)	d ₂ (inch)	K(mm)	K(inch)	**Nm	n	g	Code
*1/2"	15	16	12	95	16	5/8"	60,45	2"3/8	15	4	200	OABC012
*3/4"	20	16	12	102	16	5/8"	69,85	2"3/4	15	4	240	OABC034
*1"	25	16	16	114	16	5/8"	79,25	3"1/8	15	4	370	OABC100
*1"1/4	32	16	16	130	16	5/8"	88,90	3"1/2	25	4	530	OABC114
*1"1/2	40	16	18	133	16	5/8"	98,55	3"7/8	35	4	560	OABC112
*2"	50	16	18	162	20	3/4"	120,65	4"3/4	35	4	810	OABC200
*2"1/2	65	16	18	184	20	3/4"	139,70	5"1/2	40	4	1070	OABC212
*3"	80	16	18	194	20	3/4"	152,40	6"	40	4	1030	OABC300
*4"	100	16	18	229	20	3/4"	190,50	7"1/2	40	8	1570	OABC400
*6"	150	16	24	283	22	7/8"	241,3	9" 1/2	60	8	2400	OABC600
*8"	200	16	24	345	22	7/8"	298,45	11" 3/4	70	8	3500	OABC800
*10"	250	16	27	412	25	1"	361,95	14" 1/4	100	12	6200	OABC810
*12"	300	16	32	487	25	1"	431,8	17"	110	12	13040	OABC812

PMA maximum admissible working pressure

**nominal tightening torque

n= number of bolts

*resale products

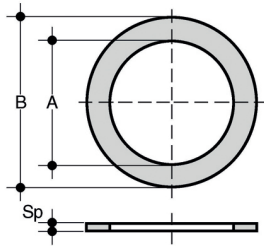

QHV/X

Flat gasket in EPDM and FKM for flanges according to EN 1092-1

d	DN	A	B	Sp	EPDM code	FKM code
20 - 1/2"	15	20	32	2	QHVX020E	QHVX020F
25 - 3/4"	20	24	38,5	2	QHVX025E	QHVX025F
32 - 1"	25	32	48	2	QHVX032E	QHVX032F
40 - 1" 1/4	32	40	59	2	QHVX040E	QHVX040F
50 - 1" 1/2	40	50	71	2	QHVX050E	QHVX050F
63 - 2"	50	63	88	2	QHVX063E	QHVX063F
75 - 2" 1/2	65	75	104	2	QHVX075E	QHVX075F
90 - 3"	80	90	123	2	QHVX090E	QHVX090F
110 - 4"	100	110	148	3	QHVX110E	QHVX110F

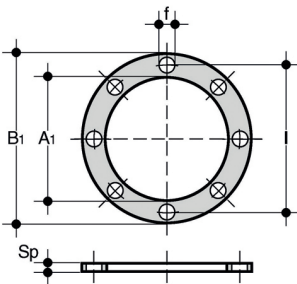

QHV/Y

Flat gasket in EPDM for flanges according to EN 1092-1, self-centring for flanges drilled PN 10/16

d	DN	A	B ₁	F	l	U	Sp	Code
20 - 1/2"	15	17	95	14	65	4	2	QHVY020E
25 - 3/4"	20	22	107	14	76,3	4	2	QHVY025E
32 - 1"	25	28	117	14	86,5	4	2	QHVY032E
40 - 1" 1/4	32	36	142,5	18	101	4	2	QHVY040E
50 - 1" 1/2	40	45	153,3	18	111	4	2	QHVY050E
63 - 2"	50	57	168	18	125,5	4	2	QHVY063E
75 - 2" 1/2	65	71	187,5	18	145,5	4	3	QHVY075E
90 - 3"	80	84	203	18	160	8	3	QHVY090E
110 - 4"	100	102	223	18	181	8	3	QHVY110E